

Rowenta

AMBIA

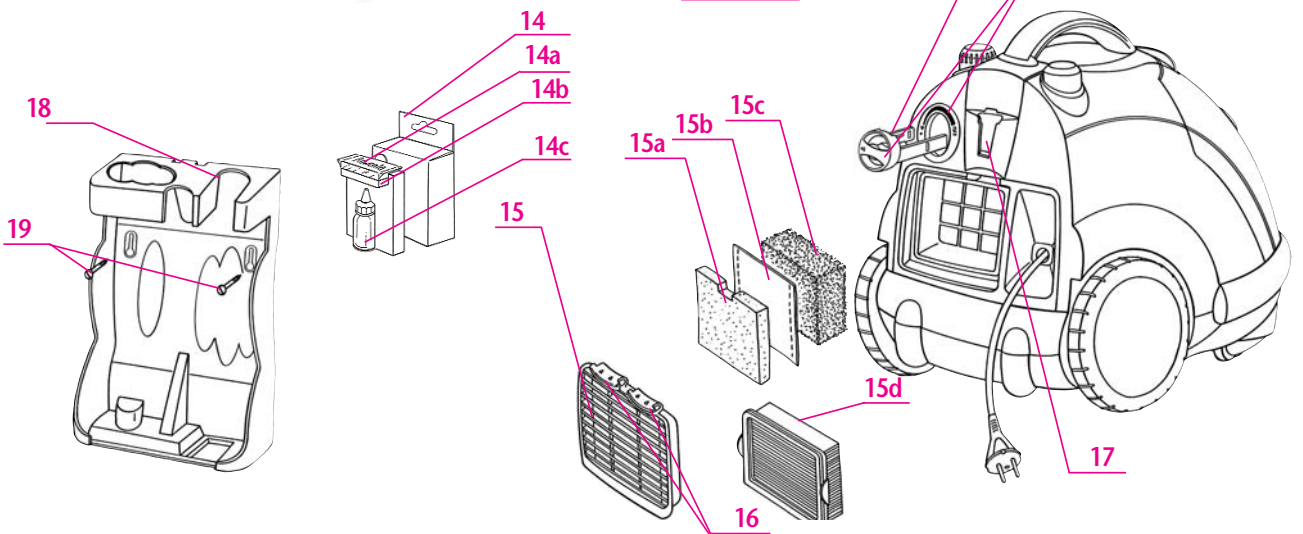
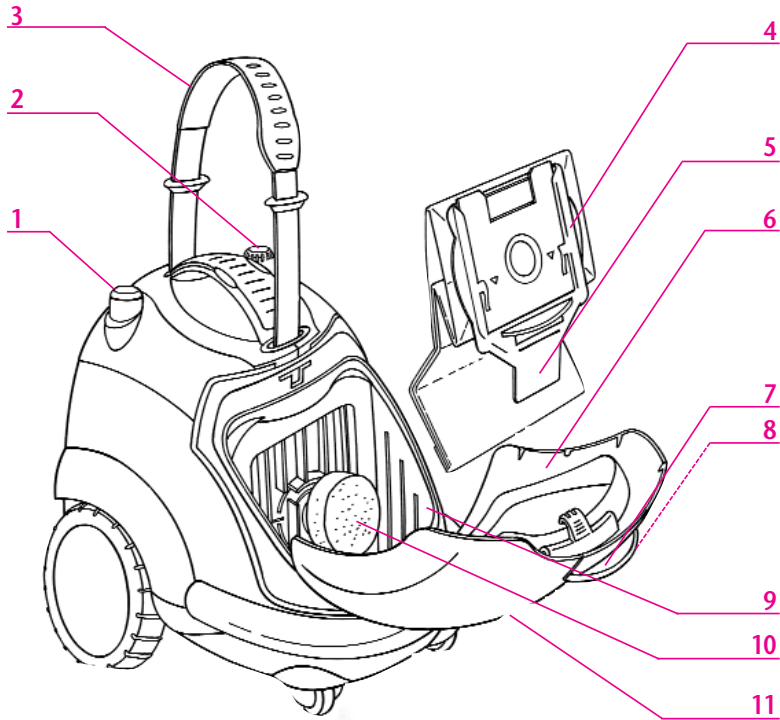

ENGLISH

Thank you for your confidence, we are sure that the AMBIA vacuum cleaner you have bought will give you complete satisfaction. Take it out of the packaging and unpack all of the accessories. Don't forget to remove the "Ambia Parfum System" kit from the packaging (according to model*)

Your vacuum cleaner includes:

1. Cord rewind button ④
2. Stop/Start control and electronic power variation (according to model*)
 - a) 2 Stop/Start positions ④
 - b) 2 Stop/Start positions ④ + 0 ◀ 1 variation
3. Carry-handle with shoulder strap
 - a) Adjustable (according to model*)
 - b) Retractable (according to model*)
4. Dust bag fastener
5. Dust bag support
6. Dust bag compartment cover
7. Lever for opening the dust bag compartment
8. Dust bag full indicator light (according to model*)
9. Dust bag compartment.
10. Motor protection foam filter
11. Suction opening
12. Adjustable perfume diffuser AMBIA PARFUM SYSTEM (according to model*)
13. Ceramic holder (according to model*)
14. Kit AMBIA PARFUM SYSTEM (according to model*)
 - a) Perfumed ceramic
 - b) Non perfumed ceramic
 - c) Perfumed essence flask
15. Air outlet grille**
 - a) Fine foam filter (according to model*)
 - b) Micro-active filter anti-bacterial (according to model*)
 - c) Thick foam filter (according to model*)
 - d) Filter cartridge HEPA FILTER SYSTEM ZR 472 (according to model*)

** Your vacuum cleaner is equipped (according to model*) with a fine-foam filter, a micro-active filter, and a thick-foam filter (a+b+c) or a HEPA filter (d)
16. Filter opening tab
17. PARK system
18. Accessory space support (according to model*)
19. Screw and plugs to fix the support (according to model*)

Standard or optional accessories (according to model*):

20. Suction hose with extra-long handle, suction control slide, integrated dusting brush (according to model*)
21. Extension tubes or telescopic tube

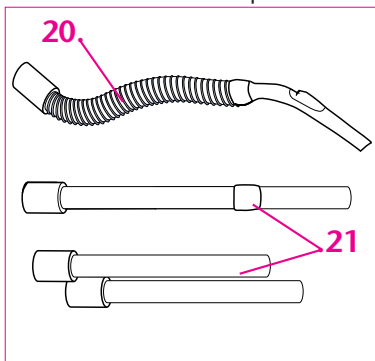

22. Floor nozzle (rugs, carpets and smooth floors).
23. Delta System nozzle (rugs, carpets and smooth floors). For fast and effective vacuuming of floors everywhere, including the tightest corners and under furniture. When vacuuming cracked stone floors or tiled surfaces, use the Delta System with its brush in the retracted position (see Delta System operating instructions).
24. Delta Activ' nozzle (For quick and effortless vacuuming on all floor surfaces. Use Delta Activ' vacuuming head with the brushes extended on smooth floors and with the brushes retracted on carpets and rugs. On wooden floors with cracks or tiles with wide joints, use Delta Activ' with the brushes retracted (see Delta Activ' operating instructions).

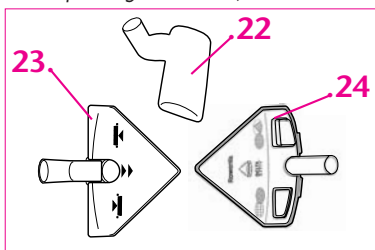

25. Crevice tool and upholstery nozzle (For crevices and furniture).
26. Swip suction duster tool

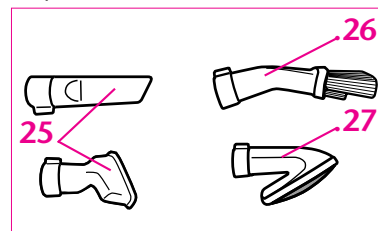

For removing dust from furniture, around ornaments, from television screens, etc.

27. Wip suction foam tool (For gentle vacuuming of furniture fabrics, curtains and drapes, etc.
28. ZR-980 turbo-brush for floors (With its air-flow driven rotating brush, the ZR Turbo Brush gives in-depth vacuuming and cleaning. It removes threads and animal hairs that have become entangled in the upholstery material.
29. ZR-08 turbo-brush for furniture (For vacuuming and in-depth cleaning with the air-driven rotating brush. It removes hair, threads and animal hairs trapped in rugs and carpets.

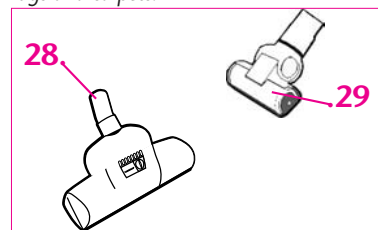

30. Double-walled anti-bacterial paper dust bags with the ZR 470 sealing system
31. RS-RT-1247 reusable cloth dust bag

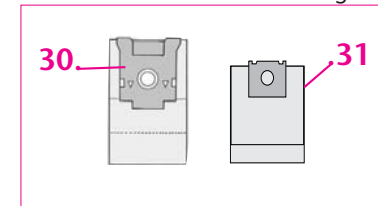

"According to model**" refers to equipment specific to certain models or accessories available as options.

HINTS AND PRECAUTIONS

- ▲ Before each use, the supply cord should be completely unwound. Do not allow it to become trapped or pulled over sharp edges. Never lift the apparatus by its cord.
- ▲ If you use an extension cord, make sure that it is in perfect condition and appropriate to the power rating of your appliance.
- ▲ Never unplug the appliance by pulling on the cord.
- ▲ Don't forget to remove the accessory storage support before switching your vacuum cleaner.
- ▲ Never use your vacuum cleaner vertically (see picture).
- ▲ When cleaning stairs, always use your vacuum cleaner with the shoulder strap, if carrying it around.
- ▲ Only use Rowenta-brand accessories, dust bags and filters.
- ▲ We recommend the use of original Rowenta perfumes (ref. ZR 474). If you use any other perfumed essences, Rowenta do not guarantee the quality of the diffused perfumes.
- ▲ Check that all the filters are properly in place. Never turn the appliance on without a dust bag and filters.

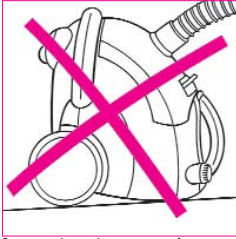

BEFORE USING AMBIA

Assemble your vacuum cleaner.

- Push the hose into the suction opening until you hear it clicks into place.

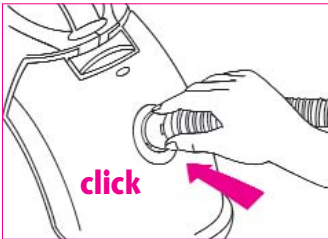

- Slide back the built-in brush (according to model*) to attach the tube(s) to the handle of the suction hose.

Adjust the length of the telescopic tube (according to model*).

- *Metal telescopic tube:* Push the adjustment button forwards, slide out the length of tube desired, then release the button to lock the tube.

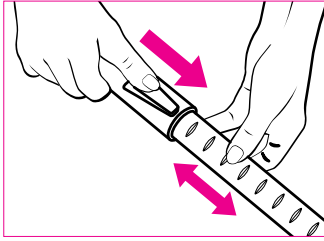

- *Plastic telescopic tube:* Slide the lower tube all the way out. To adjust the length, slide the tube in while pressing the push button.

Set up the AMBIA PARFUM SYSTEM diffusion system (according to model*).

- Turn the diffuser to the position **eject** to get the ceramic holder out of its case and take the perfumed ceramic out of its protective sachet.

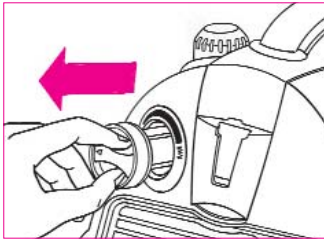

- Place the ceramic on the ceramic holder and pour a few drops (4 to 5) of perfume onto the inscription Rowenta.

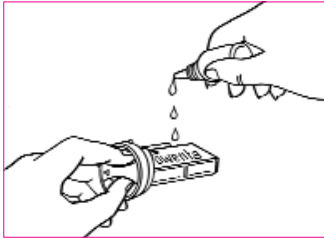

- If you want to use your own choice of perfume, wet thoroughly the non perfumed ceramic before putting it into place. In that case, Rowenta do not guarantee the quality of the diffused perfumes.

To avoid an unpleasant mixture of odours, never use different perfumes on the same ceramic.

- Put the ceramic holder with the ceramic back into its case.
- Turn the diffuser to the desired position.

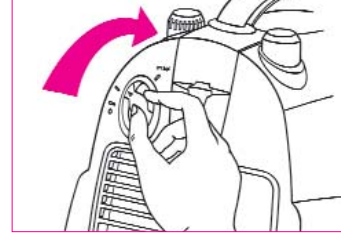

- If you put it in the position **0** there is no perfume diffusion; the more you turn towards **1** the more perfume is diffused.
- As soon as the perfume fades, take the ceramic holder out and pour a few drops of perfume (4 to 5) on the perfumed ceramic.

Important ! Never spill drops of perfume on the vacuum cleaner.

TO VACUUM WITH AMBIA

Choose the right accessory.

Be sure never to forget to remove the accessory space support (according to model*) before switching the vacuum cleaner on.

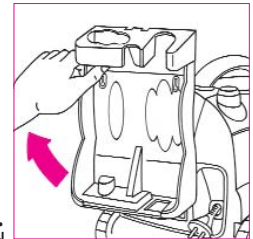

Turn on AMBIA.

- Unwind the cord completely, plug in AMBIA and press the command **⊕**.

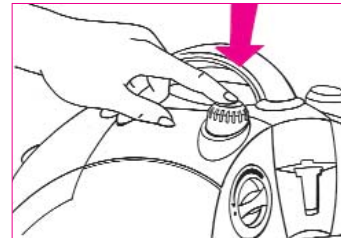

Adjust the suction power.

With the electronic power control (according to model*):

- Turn the knob to adjust the suction power: Max position for floors and Eco position for furniture and delicate surfaces.

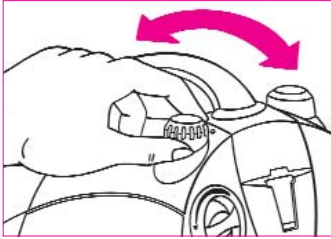

With the suction control slide :

- Open the control slide to manually reduce the suction power (ex. when the opening is blocked).

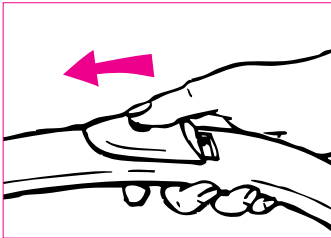

Turn off AMBIA.

- After use, press the  command and unplug your vacuum cleaner.

TO MAINTAIN AND CLEAN AMBIA

Important ! Always turn off and unplug AMBIA before maintenance or cleaning.

Change the dust bag.

- The dust bag-full indicator (according to model*) shows you that the dust bag is full or blocked by powder or dust.
- Pull the hose out: squeeze the sides of the hose, and pull.

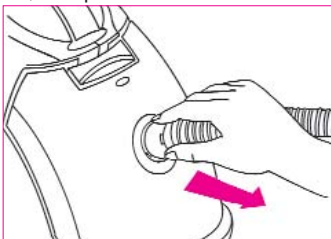

- Open the cover.

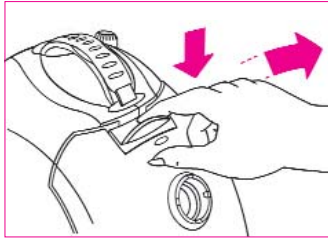

- Take the dust bag support out of its compartment.

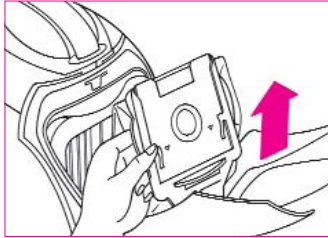

- Pull on the tab to close the dust bag, then pull the dust bag out and put it in the dustbin.

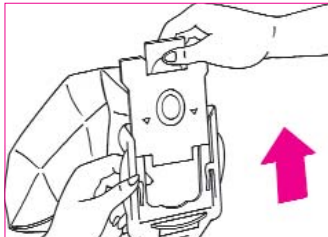

- Firmly place the shaped board of the new dust bag in the dust bag support fastener.
- Put the dust bag in place and close the cover.

Note:

Check that the dust bag is safely in place before closing the cover.

Empty the cloth dust bag (according to model*).

- Remove the cloth dust bag, hold it over a dustbin and remove the bar which holds it closed. Empty and brush the dust bag, then close it again.

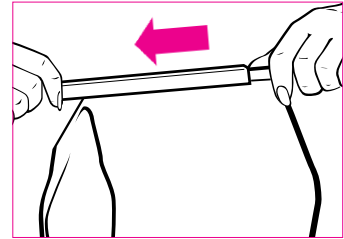

- Put back in place and close the cover again.

Important !

Check, clean and replace the various filters regularly.

Clean the foam air-intake filter.

Note: The protective foam should always be in place during use.

- Open the cover and remove the dust bag support.
- Remove the foam and clean it after every five bag changes, using lukewarm soapy water (mild washing-up liquid).

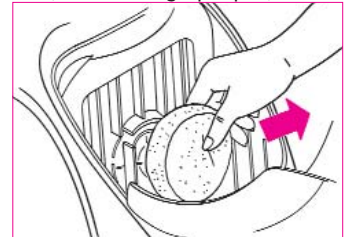

- Rinse, dry and replace the foam.

Clean the foam air outlet filter(s) (according to model*).

- Take the air outlet grille out, remove the fine foam filter and the thick foam filter and clean them – this every five dust bag changes – with lukewarm soapy water (mild detergent).



- Rinse, dry and replace the foam.

Careful!

Let the foam filters dry completely before putting them back again!

Change the micro-active filter (ref. Kit ZR 470) (according to model*).

- This should be changed with every five dust bag changes : you will find it on the thick foam filter.

Change the HEPA filter (according to model*).

Important! When you use the HEPA FILTER SYSTEM filter, don't forget to remove the filters (fine and thick) and the microactive filter.

- Remove the air outlet grille.

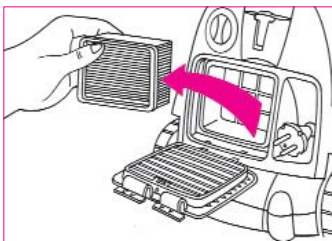

- Change it every 9 to 12 months (depending on the frequency of use).

Clean AMBIA.

- Wipe the body of the appliance and the accessories with a soft, moist cloth, then dry.
- Do not use strong or abrasive cleaning products.

TO STORE AMBIA

- Press the  command until the cord is completely rewound. The plug positions itself in its cavity.

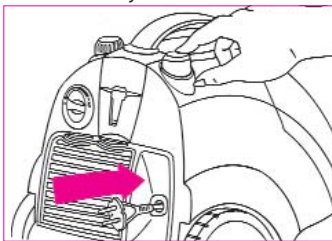

Store accessories (according to model*).

- Store accessories in the accessory storage

- Slide the suction fitting into the System-Park.

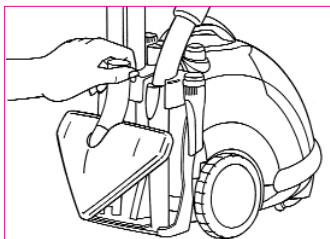

Important! You can also fix the accessory storage support onto a wall by using the fixing screws and plugs provided to this effect.



Subject to modifications!

FOR YOUR SAFETY

Read the instructions for use carefully and keep them in a safe place.

- ▲ Your vacuum cleaner is an electrical appliance: it must only be used under normal operating conditions. The appliance should be used and stored out of the reach of children. Never leave the appliance unattended when it is switched on.
- ▲ Always keep nozzles and tube ends well away from eyes and ears.
- ▲ The appliance is not intended for use by young children or infirm persons without supervision.
- ▲ Young children should be supervised to ensure that they do not play with the appliance.
- ▲ Make sure that the operating voltage of your vacuum cleaner is the same as your supply voltage - 230-240v.

- ▲ Unplug the appliance by removing the plug from the power outlet:
 - immediately after use
 - before changing accessories
 - before maintenance, cleaning or changing the dust bag.

- ▲ Do not vacuum wet surfaces, any kinds of liquids, hot substances, ultra-fine substances (plaster, cement, ash, etc.) large sharp debris (glass), dangerous products (solvents, stripping compounds, etc.), chemical products (acids, cleaners, etc.), inflammable or explosive products (petrol- or alcohol-based).

- ▲ Do not immerse the appliance in water or store it outdoors.
- ▲ Do not use the appliance:
 - if it has been dropped and shows signs of damage or functions abnormally.
 - if the supply cord is defective
 In this case do not open the appliance and call our helpline (overleaf).

- ▲ Repairs should only be carried out by specialists using original replacement parts. It is dangerous to try to repair an appliance by yourself.

- ▲ Vacuum cleaner supply cords and winding systems must, in all cases, be replaced by an approved Service Centre.

- ▲ In accordance with current regulations, before disposing of an appliance no longer needed, the appliance should be made non-operational (by unplugging it and cutting off the electricity supply cord).

- ▲ The company cannot accept responsibility for damage arising from professional use, improper use or failure to comply with the instructions for use. The guarantee will be invalidated.

Your appliance conforms to the 73/23 EEC and 89/336 EEC directives.

WHAT TO DO IF :

Important! As soon as your vacuum cleaner starts to malfunction, and before performing any checks:

- Stop the appliance by pressing the Start/Stop switch ①.
- Unplug the appliance.

AMBIA will not start.

- The product is not connected to the mains Check that the product is correctly plugged in.
Check the fuse and your mains supply circuit breaker.

AMBIA does not suck.

- Either a tool or the hose is blocked Unblock the tool or the hose.

AMBIA sucks less effectively, makes more noise than usual, and whistles.

- A tool or the hose is partially blocked Unblock the tool or the hose.
- The bag is full or blocked by fine dust Replace the bag or empty the cloth bag.
- The foam filters and microactive filter are full Clean the foam filters and replace the microactive filter.
- The HEPA filter is full Change the HEPA filter.
- The cover is not properly closed Check the position of the bag on its support.
Check the position of the bag support.
- The air regulator is open Close the air regulator.
- The electronic power selector is in the min. position. . . Increase power using the electronic power selector (except when vacuuming delicate fabrics).

The dust bag full indicator stays red.

- The bag is full Replace the bag or empty the cloth bag.
- The nozzle is difficult to remove Open the suction control or reduce its power.

AMBIA stops while vacuuming.

- The thermal cut-off switch has activated Clean the motor filter, change the micro-active filter (according to model*) and replace the bag. Allow the AMBIA to cool down for 30 minutes before switching on again.

The power cord does not fully retract.

- The cord slows down as it is retracted Pull out the cord until completely extended and press on the retraction button ②.

The dust bag compartment cover will not close.

- The dust bag compartment cover has been knocked out of place. Put it back in place by putting the flaps back in their holds.

Your vacuum cleaner no longer diffuses scent.

- There is no more perfume in the ceramic Put a few more drops of perfume on the ceramic.

You are pouring some perfume on the ceramic.

- Drops of perfume fall on the product Wipe immediately the vacuum cleaner with a moist cloth.

**If the problem persists take the AMBIA to your nearest Rowenta Approved Service Centre.
Helpline : 0845 602 1454 (UK calls charged at local rate) (01) 47 51947 (IRELAND).**